

DZQ 60/8 B

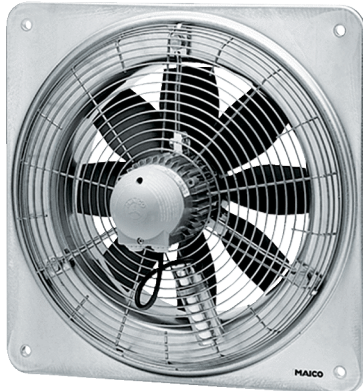

Short description

Axial wall fan with square wall plate, DN 600, three-phase AC

Application examples

Production facility, Commercial premises, Garage, Building container, Storage facility

Article number 0083.0064

Technical data

Model	Square wall plate
Air flow volume	7.420 m ³ /h
Air volume _{nom}	5.250 m ³ /h (in opt. efficiency)
Pressure p _{fs, nom}	50 Pa (in opt. efficiency)
Rotating speed n _{nom}	685 1/min (in opt. efficiency)
Rotating speed	703 1/min
Impeller type	axial
Speed controllable	✓
Reversing capacity	✓
Type of voltage	Three-phase AC
Rated voltage	400 V
Frequency	50 Hz
Nominal output	243 W (in opt. efficiency)
I _{nom}	0,65 A (in opt. efficiency)
I _{max}	0,85 A
Degree of protection	IP 55
Insulation class	F
Pole-changeable	–
Mains cable	7 x 1,5 mm ²
Installation site	Wall / Ceiling
Type of installation	Surface-mounted
Installation position	horizontal / vertical
Material	Sheet steel, galvanised
Colour	Silver
Weight	22 kg
Weight including packaging	28 kg
Nominal size	600 mm
Width	820 mm
Height	820 mm

DZQ 60/8 B

Depth	342 mm
Width with packaging	845 mm
Height with packaging	845 mm
Depth with packaging	435 mm
Airstream temperature at nominal current	-20 °C up to 60 °C
Airstream temperature at I _{Max}	-20 °C up to 60 °C
Packing unit	1 piece
Range	C
GTIN (EAN)	4012799830641

Technical data according to ErP in Best Efficiency Point (BEP)

Total efficiency η	30 %
Measurement category	A
Efficiency category	static
Efficiency level N	40,2
VSD necessary	No
Year of manufacture	see rating plate
Manufacturer's name / official registration number / manufacturer's place of establishment	Maico Elektroapparate-Fabrik GmbH / Freiburg registration court, HRB 601233 / Villingen-Schwenningen
Art. No.	0083.0064
P _{BEP} / Air volume _{BEP} / P _{is, BEP}	0,243 kW / 5.250 m ³ /h / 50 Pa
η_{BEP}	685 1/min
Specific ratio	≈ 1
Information about dismantling and disposal	see mounting instructions
Information about installation, operation and repairs	see mounting instructions
Objects used to measure efficiency which are not described by the measurement category	-
Sound power level _{L_{WA7}}	69 dB(A)

Sound power level in octave range

	63 Hz	125 Hz	250 Hz	500 Hz	1 kHz	2 kHz	4 kHz	8 kHz	Total
L_{WA7, S1} (dB(A))	-	-	-	-	-	-	-	-	37
L_{WA7, S2} (dB(A))	-	-	-	-	-	-	-	-	49
L_{WA7, S3} (dB(A))	-	-	-	-	-	-	-	-	57
L_{WA7, S4} (dB(A))	-	-	-	-	-	-	-	-	65
L_{WA7, S5} (dB(A))	36	57	58	63	67	65	57	46	71

DZQ 60/8 B

	63 Hz	125 Hz	250 Hz	500 Hz	1 kHz	2 kHz	4 kHz	8 kHz	Total
L _{WA8, S1} (dB(A))	-	-	-	-	-	-	-	-	38
L _{WA8, S2} (dB(A))	-	-	-	-	-	-	-	-	54
L _{WA8, S3} (dB(A))	-	-	-	-	-	-	-	-	64
L _{WA8, S4} (dB(A))	-	-	-	-	-	-	-	-	75
L _{WA8, S5} (dB(A))	50	59	61	64	70	70	71	69	77

L_{WA7}= housing and free inlet sound power level in dB.
 L_{WA8}= housing and free outlet sound power level in dB.

Characteristic curve

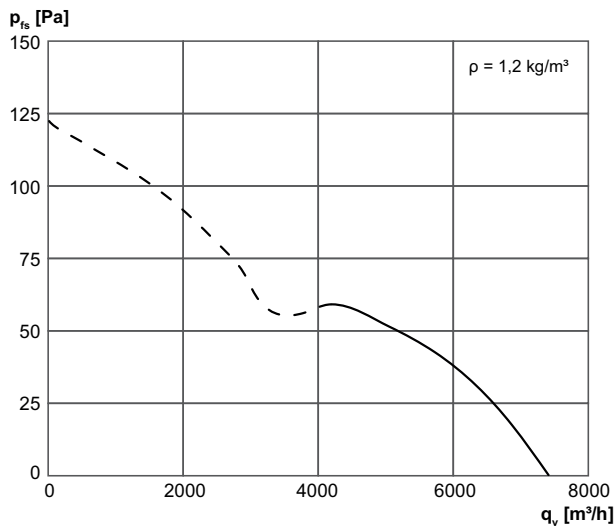

Dimensioned drawing [mm]

- ① Steel wall plate = EZQ/DZQ model
- ② Steel wall ring = EZS/DZS model

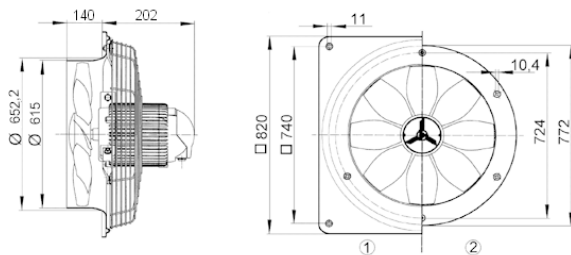

DZQ 60/8 B

