

GRM HD 25/4 Ex

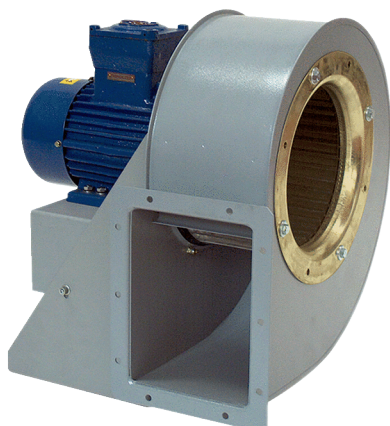

Short description

Centrifugal blower made of metal for high-pressure applications, 4-pole, size 250, three-phase AC, for use in potentially explosive atmospheres, medium: gas

Application examples

explosion-proof industrial applications

Article number 0073.0401

Technical data

| | |
|--|--|
| Air flow volume | 2.893 m ³ /h |
| Rotating speed | 1.460 1/min |
| Impeller type | radial |
| Speed controllable | ✓ |
| Reversing capacity | – |
| Type of voltage | Three-phase AC |
| Rated voltage | 400 V |
| Frequency | 50 Hz |
| Nominal output | 750 W |
| I _{nom} | 2 A |
| Degree of protection | IP 55 |
| Insulation class | F |
| Pole-changeable | – |
| Installation site | Duct connection |
| Installation position | Horizontal |
| Material | Sheet steel, galvanised |
| Housing material | Steel, coated |
| Colour | grey |
| Weight | 39 kg |
| Weight including packaging | 41 kg |
| Size | 250 mm |
| Width | 438 mm |
| Height | 528 mm |
| Depth | 530 mm |
| Width with packaging | 500 mm |
| Height with packaging | 530 mm |
| Depth with packaging | 560 mm |
| EX designation in accordance with the ATEX Directive | Ex II 2 G |
| EX designation in accordance with standard | Ex db IIB+H2 T4 Gb X / Ex h IIB+H2 T4 Gb X |

GRM HD 25/4 Ex

| | |
|------------------------|----------------------|
| Ta ambient temperature | -20 °C ≤ Ta ≤ +40 °C |
| Operating mode | S1 |
| PTC DIN 44082 | M 100 |
| Temperature class | T4 |
| Packing unit | 1 piece |
| Range | C |
| GTIN (EAN) | 4012799734017 |

Sound power level in octave range

| | 63 Hz | 125 Hz | 250 Hz | 500 Hz | 1 kHz | 2 kHz | 4 kHz | 8 kHz | Total |
|--|-------|--------|--------|--------|-------|-------|-------|-------|-------|
| L_{WA5, S5} (dB(A)) | 53 | 65 | 71 | 74 | 79 | 72 | 64 | 54 | 81 |

L_{WA5}= free inlet sound power level in dB.

Characteristic curve

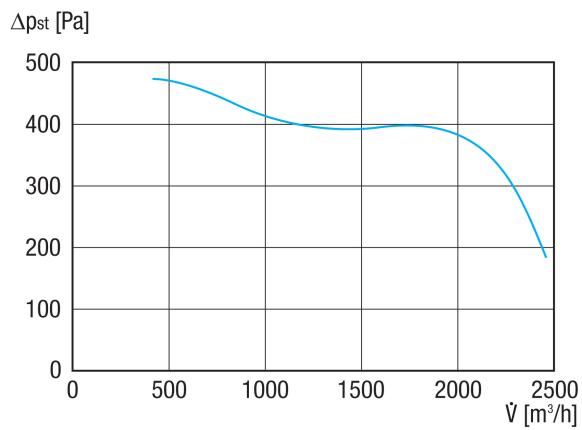

GRM HD 25/4 Ex

Dimensioned drawing [mm]

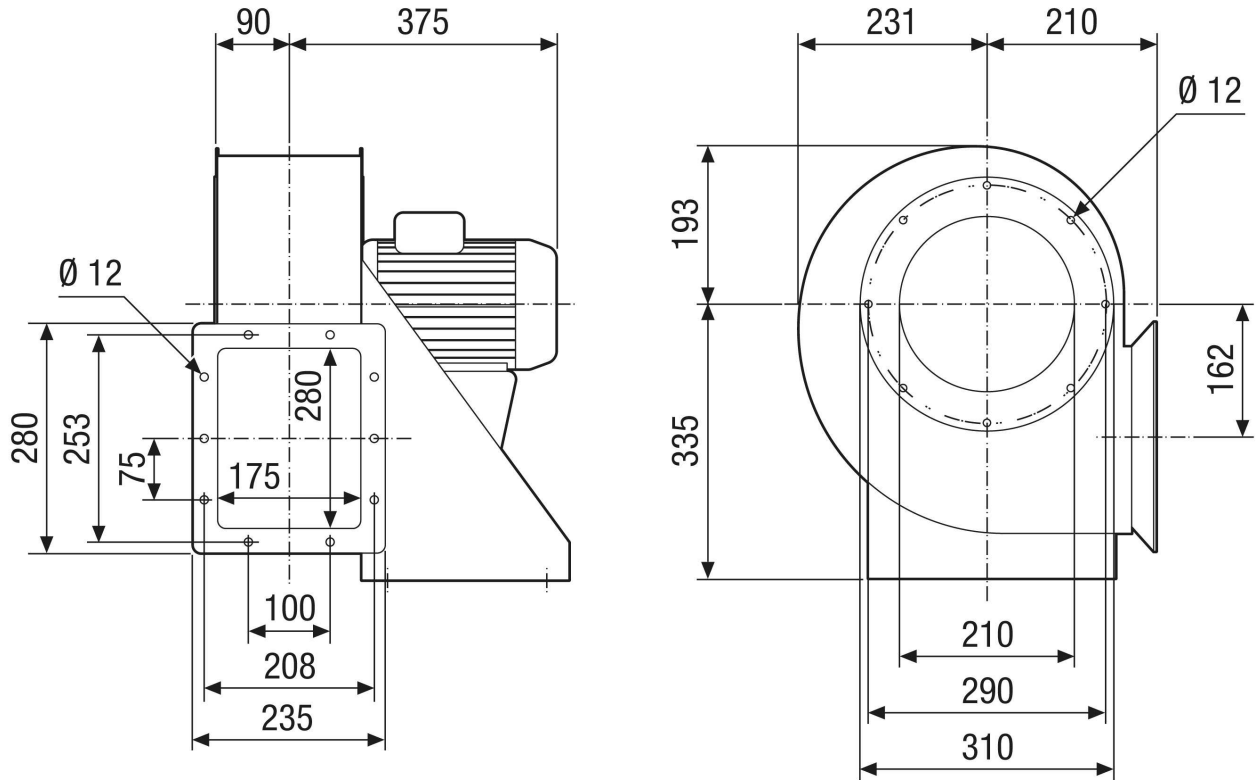

GRM HD 25/4 Ex

Dimensioned drawing Housing orientation [mm]

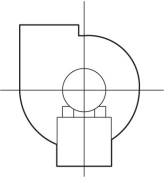
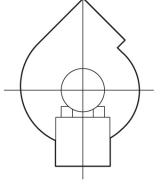
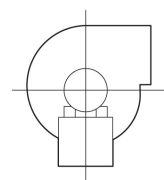
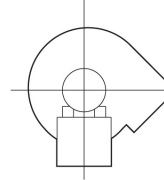
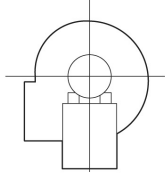
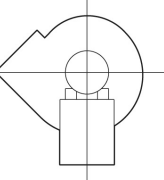
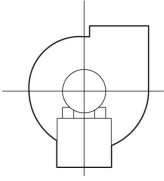
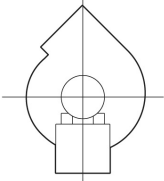
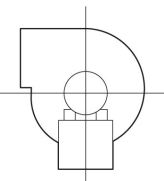
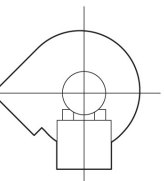
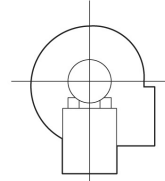
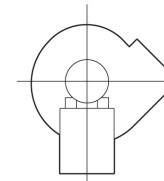
| | | | | | | |
|---|--|--|--|---|--|--|
| ① |  |  |  |  |  |  |
| | 0° | 45° | 90° | 135° | 270° | 315° |
| ② |  |  |  |  |  |  |

① RD Right-hand version

② LG Left-hand version

The GRK 12/2 E and GRK 12/4 D variants are not available in right-hand version RD!

The standard orientation is always LG 270°