

KSP 28/23



Short description

Attenuating sound absorber, channel dimensions 700 mm x 300 mm

Article number 0092.0332

Technical data

Min. flow velocity	
Max. flow velocity	20 m/s
Installation site	Channel
Housing material	Sheet steel, galvanised
Weight	48,5 kg
Weight including packaging	48,54 kg
Channel dimension	700 mm x 300 mm
Width	740 mm
Height	340 mm
Depth	1.500 mm
Width with packaging	740 mm
Height with packaging	340 mm
Depth with packaging	1.500 mm
Insertion loss at 63 Hz	4 dB
Insertion loss at 125 Hz	11 dB
Insertion loss at 250 Hz	23 dB
Insertion loss at 500 Hz	21 dB
Insertion loss at 1 kHz	23 dB
Insertion loss at 2 kHz	18 dB
Insertion loss at 4 kHz	14 dB
Insertion loss at 8 kHz	10 dB
Total insertion loss	
Insertion loss note	
Packing unit	1 piece
Range	D
GTIN (EAN)	4012799923329

KSP 28/23

Characteristic curve

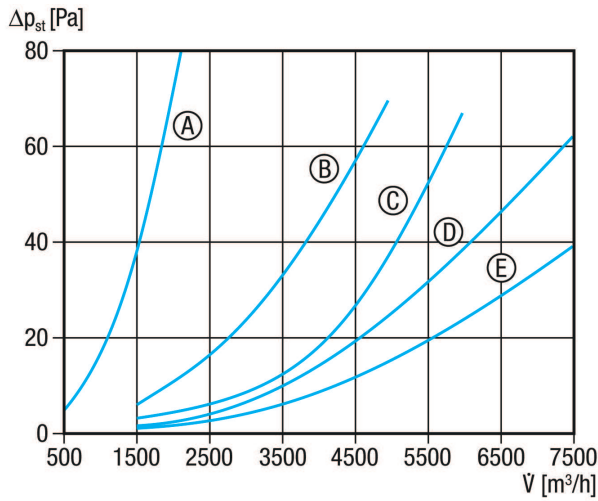

- ① KSP 22/27
- ② KSP 25/27
- ③ KSP 28/23
- ④ KSP 31/27, KSP 93/28
- ⑤ KSP 35/23, KSP 94/28
- ⑥ KSP 50/23
- ⑦ KSP 56/25

Dimensioned drawing [mm]

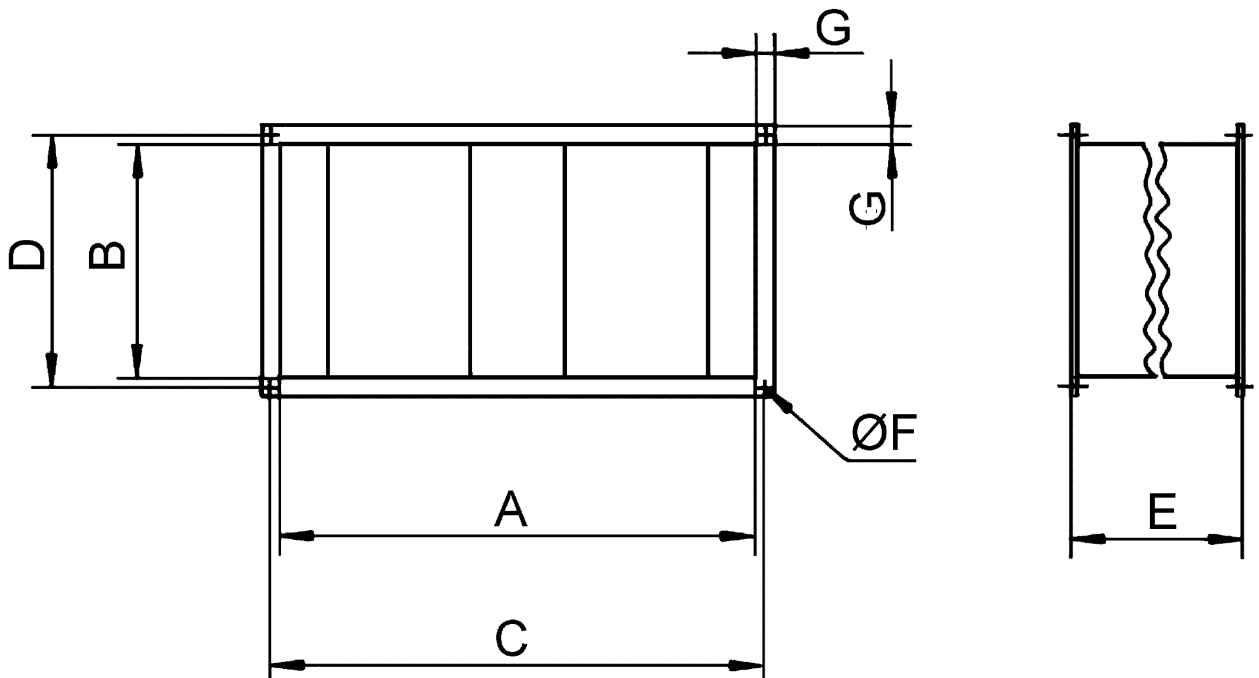

A	B	C	D	E	F	G
700	300	720	320	1.500	12	20

KSP 28/23

