

KSP 35/23



Short description

Attenuating sound absorber, channel dimensions 1,050 mm x 400 mm

Article number 0092.0334

Technical data

Min. flow velocity	
Max. flow velocity	20 m/s
Installation site	Channel
Housing material	Sheet steel, galvanised
Weight	78 kg
Weight including packaging	78 kg
Channel dimension	1.000 mm x 400 mm
Width	1.040 mm
Height	440 mm
Depth	1.500 mm
Width with packaging	1.040 mm
Height with packaging	440 mm
Depth with packaging	1.500 mm
Insertion loss at 63 Hz	4 dB
Insertion loss at 125 Hz	11 dB
Insertion loss at 250 Hz	23 dB
Insertion loss at 500 Hz	21 dB
Insertion loss at 1 kHz	23 dB
Insertion loss at 2 kHz	18 dB
Insertion loss at 4 kHz	14 dB
Insertion loss at 8 kHz	10 dB
Total insertion loss	
Insertion loss note	
Packing unit	1 piece
Range	D
GTIN (EAN)	4012799923343

KSP 35/23

Characteristic curve

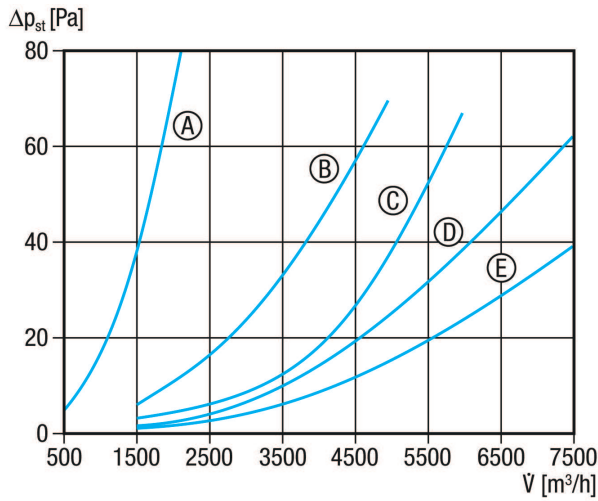

- ① KSP 22/27
- ② KSP 25/27
- ③ KSP 28/23
- ④ KSP 31/27, KSP 93/28
- ⑤ KSP 35/23, KSP 94/28
- ⑥ KSP 50/23
- ⑦ KSP 56/25

Dimensioned drawing [mm]

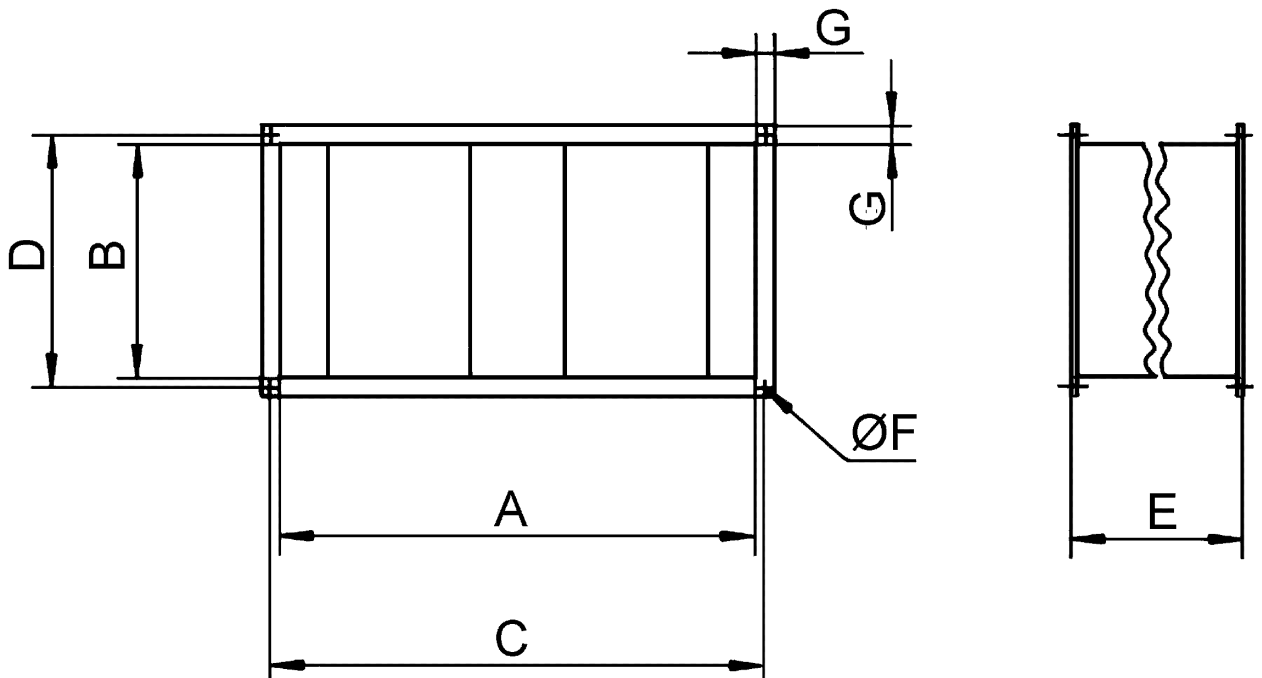

A	B	C	D	E	F	G
1.000	400	1.020	420	1.500	12	20

KSP 35/23

