

KSP 93/28



Short description

Attenuating sound absorber, channel dimensions 900 mm x 300 mm

Article number 0092.0504

Technical data

Min. flow velocity	
Max. flow velocity	20 m/s
Installation site	Channel
Housing material	Sheet steel, galvanised
Weight	47,5 kg
Weight including packaging	47,5 kg
Channel dimension	900 mm x 300 mm
Width	940 mm
Height	340 mm
Depth	1.250 mm
Width with packaging	940 mm
Height with packaging	340 mm
Depth with packaging	1.250 mm
Insertion loss at 63 Hz	4 dB
Insertion loss at 125 Hz	16 dB
Insertion loss at 250 Hz	28 dB
Insertion loss at 500 Hz	28 dB
Insertion loss at 1 kHz	33 dB
Insertion loss at 2 kHz	27 dB
Insertion loss at 4 kHz	17 dB
Insertion loss at 8 kHz	13 dB
Total insertion loss	
Insertion loss note	
Packing unit	1 piece
Range	D
GTIN (EAN)	4012799925040

KSP 93/28

Characteristic curve

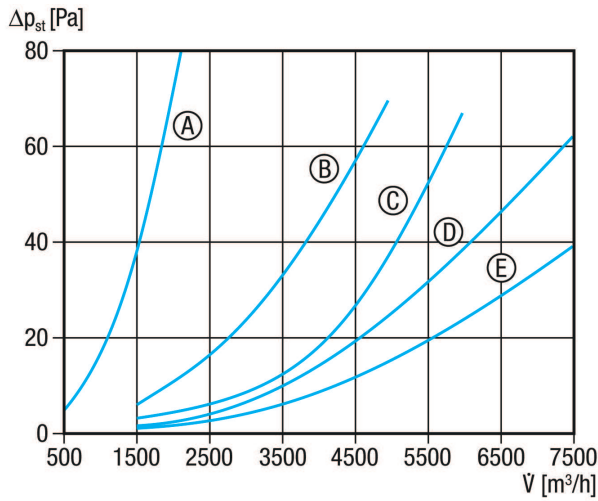

- ① KSP 22/27
- ② KSP 25/27
- ③ KSP 28/23
- ④ KSP 31/27, KSP 93/28
- ⑤ KSP 35/23, KSP 94/28
- ⑥ KSP 50/23
- ⑦ KSP 56/25

Dimensioned drawing [mm]

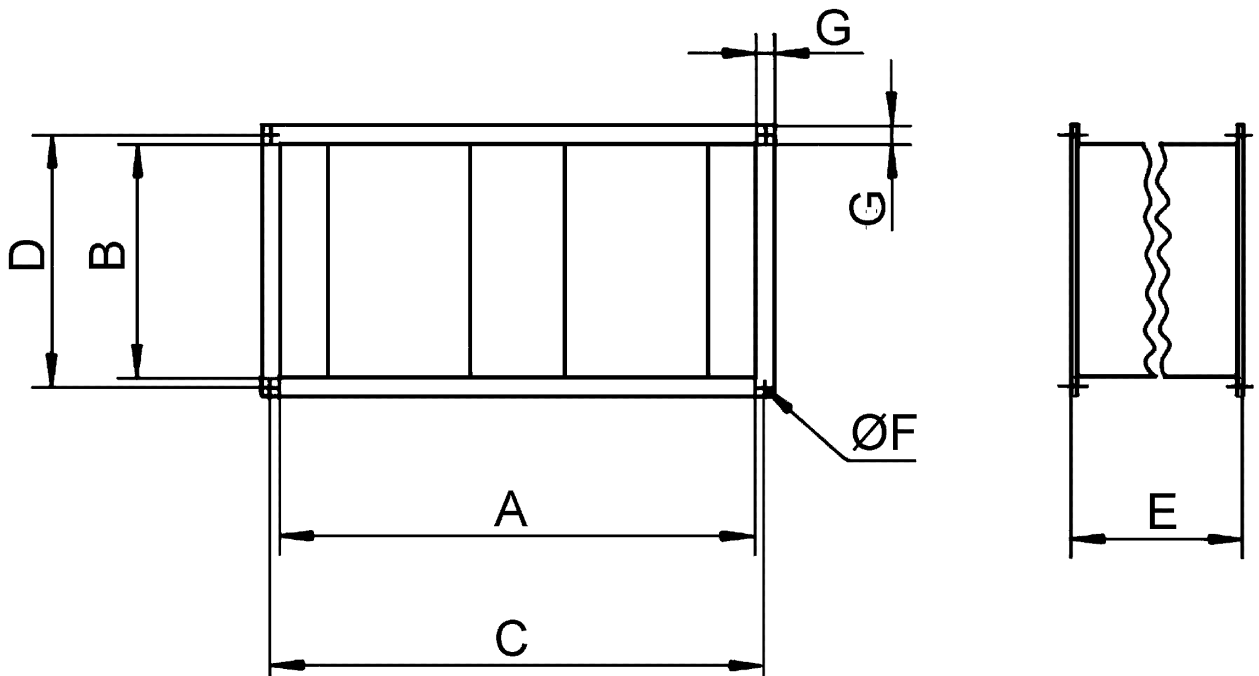

A	B	C	D	E	F	G
900	300	920	320	1.250	9	20

KSP 93/28

