

# SZ 22

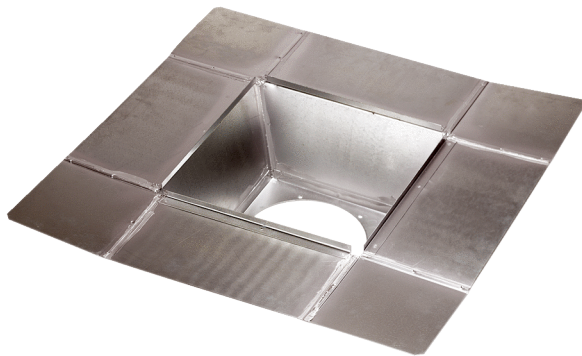

## Short description

For a connection between the SD 22 socket sound absorber and the ventilation ducts that is economical in terms of air flow and easy to mount, for installation in flat roofs

Article number 0092.0287

## Technical data

Installation site	Roof
Housing material	Sheet steel, galvanised
Weight	6,8 kg
Weight including packaging	6,82 kg
Suitable for nominal size	225 mm
Width	800 mm
Height	800 mm
Depth	180 mm
Width with packaging	800 mm
Height with packaging	800 mm
Depth with packaging	180 mm
Ambient temperature	100 °C
Packing unit	1 piece
Range	C
GTIN (EAN)	4012799922872

## Dimensioned drawing [mm]

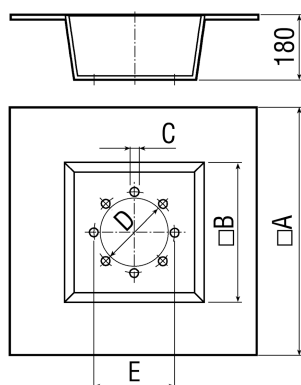

A	B	C	D	E
800	400	7	238	259

SZ 22

