

SZ 31

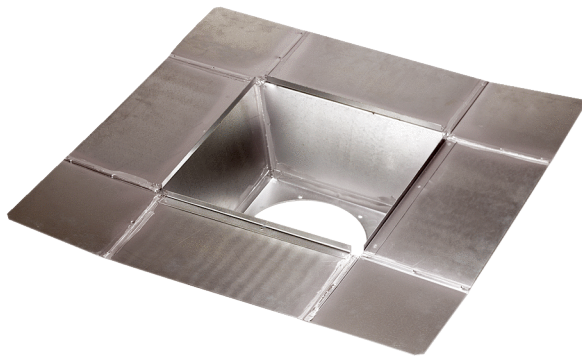

Short description

For a connection between the SD 31 socket sound absorber and the ventilation ducts that is economical in terms of air flow and easy to mount, for installation in flat roofs

Article number 0092.0289

Technical data

Installation site	Roof
Housing material	Sheet steel, galvanised
Weight	8,3 kg
Weight including packaging	8,33 kg
Suitable for nominal size	315 mm
Width	910 mm
Height	910 mm
Depth	180 mm
Width with packaging	910 mm
Height with packaging	910 mm
Depth with packaging	180 mm
Ambient temperature	100 °C
Packing unit	1 piece
Range	C
GTIN (EAN)	4012799922896

Dimensioned drawing [mm]

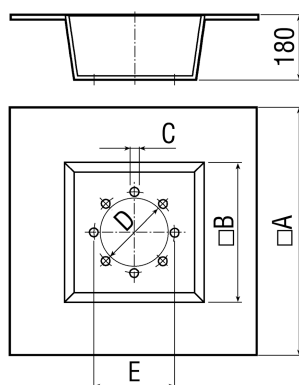

A	B	C	D	E
910	510	9,5	312	356

SZ 31

