

GRM ES 16/2 D

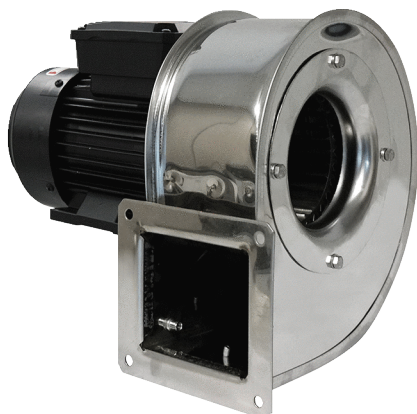

Kratka informacija

Radijalno puhalo metalni s kućištem od plemenitog čelika, ugradna veličina 160, trofazna struja

Primjeri primjene

Industrijska primjena

Broj artikla

0073.0323

Tehnički podaci

| | |
|---|-------------------------|
| Volumen zraka | 2.318 m ³ /h |
| Brzina | 2.880 1/min |
| Tip propelera | radijalni |
| S mogućnošću upravljanja brzinom | ✓ |
| Mogućnost obrnutog načina rada | – |
| Vrsta napona | Trofazna struja |
| Nazivni napon | 400 V |
| Frekvencija struje | 50 Hz |
| Nominalna snaga | 750 W |
| I _{Nomin.} | 1,7 A |
| Vrsta zaštite | IP 55 |
| Toplinska klasa | F |
| Moguća promjena pola | – |
| Mjesto ugradnje | Cijevni priključak |
| Položaj za ugradnju | horizontalno |
| Materijal kućišta | Plemeniti čelik |
| Materijal propelera | Plemeniti čelik |
| Boja | srebrna |
| Težina | 17 kg |
| Težina s pakovanjem | 18 kg |
| Ugradna veličina | 160 mm |
| Širina | 390 mm |
| Visina | 355 mm |
| Dubina | 318 mm |
| Širina s pakovanjem | 520 mm |
| Visina s pakovanjem | 480 mm |
| Dubina s pakovanjem | 440 mm |
| Temperatura struje zraka kod I _{Maks.} | -20 °C do 80 °C |
| PTC DIN 44082 | M 100 |

GRM ES 16/2 D

| | |
|-----------------------|---------------|
| Jedinica za pakiranje | 1 kom |
| Asortiman | C |
| GTIN (EAN) | 4012799733232 |

Razina jačine zvuka u opsegu buke

| | 63 Hz | 125 Hz | 250 Hz | 500 Hz | 1 kHz | 2 kHz | 4 kHz | 8 kHz | Ukupno |
|--|-------|--------|--------|--------|-------|-------|-------|-------|--------|
| L_{WA5, S5} (dB(A)) | 53 | 64 | 79 | 81 | 82 | 83 | 81 | 75 | 89 |

L_{WA5} = razina jačine zvuka slobodnog usisa u dB

Krivulja

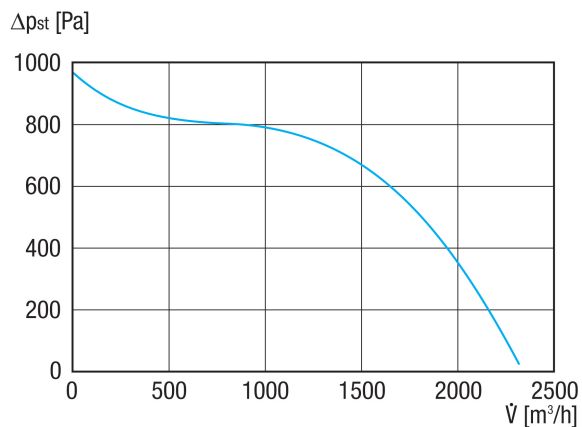

GRM ES 16/2 D

Crtež s veličinama [mm]

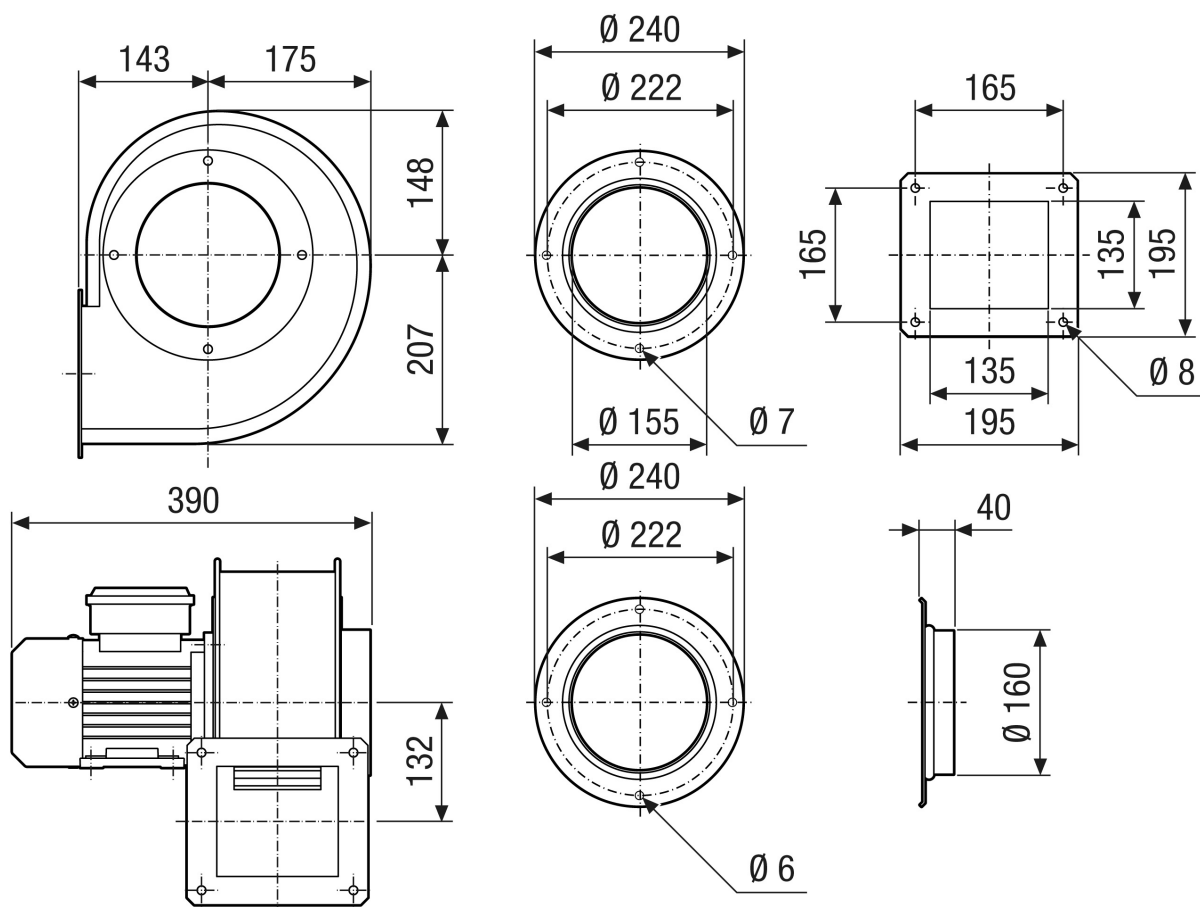

GRM ES 16/2 D

Crtež s veličinama Poravnanje kućišta [mm]

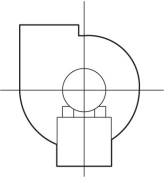
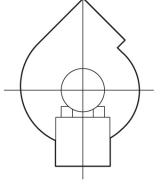
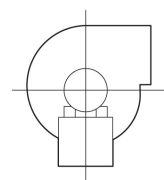
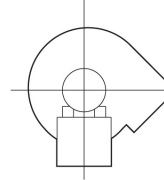
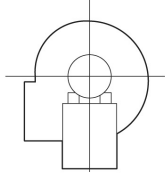
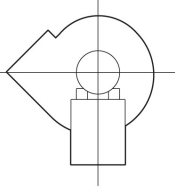
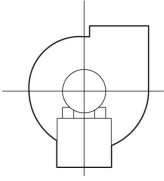
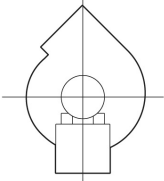
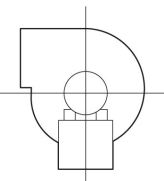
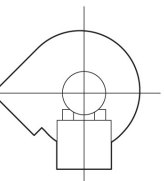
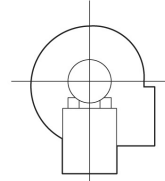
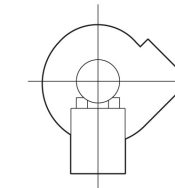
| | | | | | | |
|---|--|--|--|---|--|--|
| ① |  |  |  |  |  |  |
| | 0° | 45° | 90° | 135° | 270° | 315° |
| ② |  |  |  |  |  |  |

① RD model na desnoj strani

② LG model na lijevoj strani

Varijante GRK 12/2 E i GRK 12/4 D nisu dostupne u modelu na desnoj strani RD!

Standardno namještanje je uvijek LG 270°